

# ASSEMBLY INSTRUCTIONS / PARTS

## REMOTE HOSE KIT

### PARTS LIST

REF. NO.	PART NO.	QTY.	DESCRIPTION
1	1509-90	1	Hex Bolt, 1/4-20 x 1-1/4" Lg.
2	43866	1	Hex Bolt, 1/4-20 x 5/8" Lg.
3	43013	2	Hex Lock Nut, 1/4-20 Thd.
4	720-0281	1	Grip
5	726-0327	2	Adj. Hose Clamp 5" Dia.
6	731-01562	1	Hose Adapter
8	44695	1	Bowed Washer, .32" I.D.
9	749-0005	1	Handle
10	48772	1	Hose, 5" Dia.
11	731-01524	1	Nozzle Tube

### ASSEMBLY INSTRUCTIONS

1. Place handle (Ref. 9) in position on nozzle tube (Ref. 11). Secure front of handle to nozzle tube with hex bolt 5/8" long (Ref. 2) and hex lock nut (Ref. 3). Do not tighten at this time.
2. Place bowed washer (Ref. 8) on hex bolt 1-1/4" long (Ref. 1), with the crowned side of the washer against the head of the hex bolt.
3. Place hex bolt (with washer attached) down through the rear hole in the handle and nozzle tube. Secure with hex lock nut (Ref. 3). Tighten both hex bolts and nuts securely.
4. Slide a hose clamp (Ref. 5) onto each end of the hose (Ref. 10), loosening the clamps if necessary. Slide one end of hose over the round end of the nozzle tube, and secure with hose clamp. Slide other end of hose over the kit's hose adapter and secure with hose clamp. Make certain both hose clamps are tightened securely.
5. Remove the Vac's hose adapter by removing the three wing nuts. Place the kit's hose adapter onto the weld studs, and secure with the three wing nuts just removed.

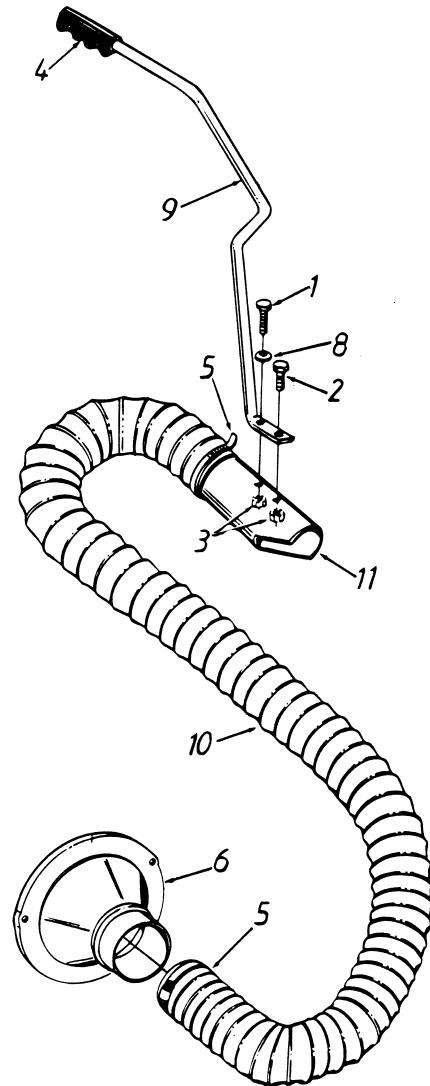

**WARNING:** Be certain to stop the engine and disconnect the spark plug wire from the spark plug before attaching or removing the vacuum from the Vac.

### REPAIR PARTS

303 West Raymond  
Sullivan, IL. 61951  
217-728-8388